

## Submersible motor pumps with mixer head for abrasive drainage water.

# HBPR504, HBPR508

### Application

Pump for conveying clean or soiled water, also containing abrasive sand or sludge. This series is also equipped with a stainless steel mixer head to enable a strong pumping effect with muddy and greasy media. Application areas are e.g. cellar draining, water table drawdown, drainage of construction sites or shafts, application on board ships, emergency deployment for flooding etc.

**Installation:** Stationary or mobile.

Version with float switch for use as automatic water level controlled drainage pump.

**Pumped medium:** Clear- and drainage water with abrasive sand or mud additives, max. temperature of pumped medium: 40°C

**Operating mode:** Continuous operation (S1).

### Design

Fully submersible pump, consisting of:

**Pump:** Single stage centrifugal pump with low situated discharge.

**Impeller:** Vortex impeller

**Motor:** Pressure watertight, medium-immersed motor, Insulation class F, Protection rating IP 68. Cable connection chamber totally isolated from motor housing. Thermal sensor for temperature monitoring in the winding. Connecting cable: H07RN8-F3G1

**Shaft/bearing:** strongly dimensioned chrome steel shaft, lifetime-lubricated roller bearings.

**Seal:** Shaft seal combined with a double action mechanical seal in oil bath.

### Conveying capacity

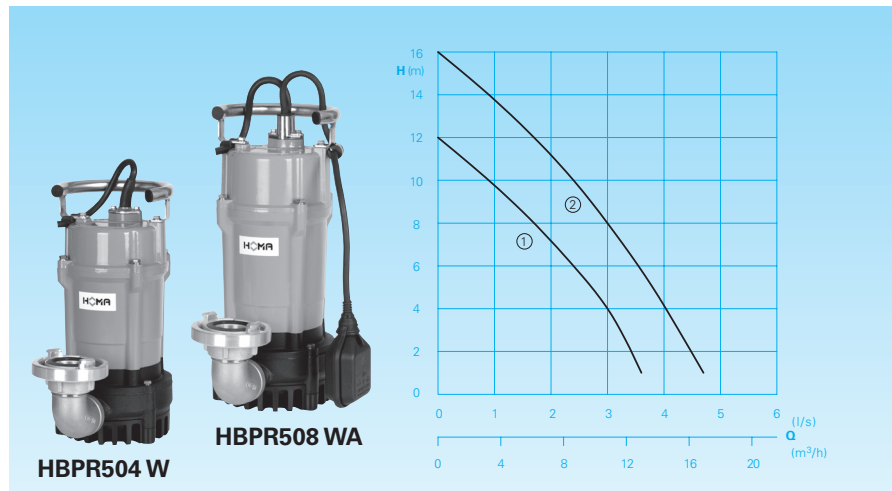

### Technical data

Curve No.	Pump type	Motor input		Nominal current (A)	Free passage (mm)	Weight (kg)
		P <sub>1</sub> (kW)	P <sub>2</sub> (kW)			
①	HBPR504 W(A)	0,70	0,40	3,0	6	14,0
②	HBPR508 W(A)	1,20	0,75	5,0	6	16,0

**Rotational speed:** 2850 rpm

**Discharge:** BSP1 1/2

**Model W:** 230V/1Ph 50Hz

**Model A:** with automatic float switch HOMA-Nivomatik

### Materials

Motor housing, motor bearing housing, motor housing cover	Aluminium
Motor shaft	Stainless steel
Screws	Stainless steel
Impeller	Cast iron GJS
Pump housing	Cast iron GJL
Suction sieve	Rubber
Shaft seal	Shaft sealing ring NBR + double action mechanical seal Ceramic/Coal/SIC
Elastomers	NBR

### Scope of supply

Pump with 10 m of connecting cable, C-Coupling and 90° connection bend.

**Model A:** With automatic float switch HOMA Nivomatik.

**Dimensions and installation example** (all dimensions in mm)

**HBPR504 WA, HBPR508 WA**

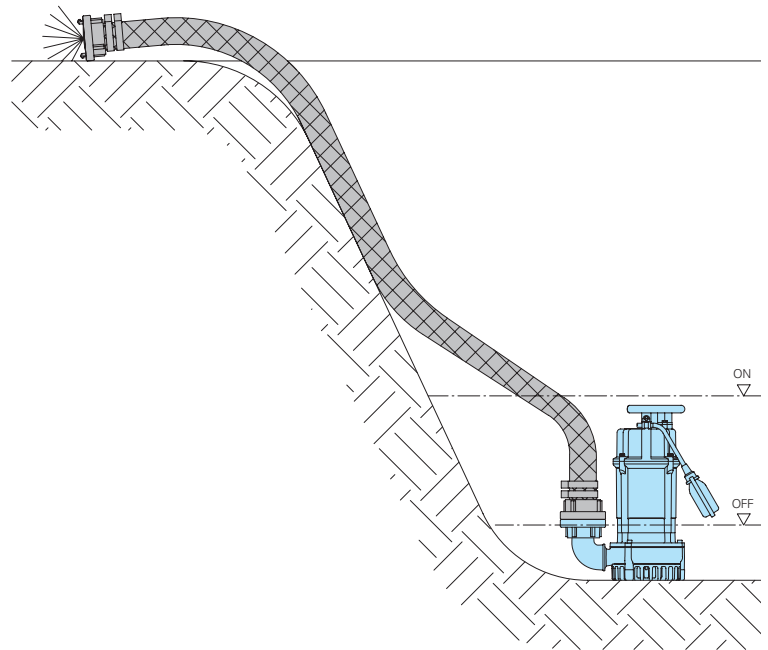
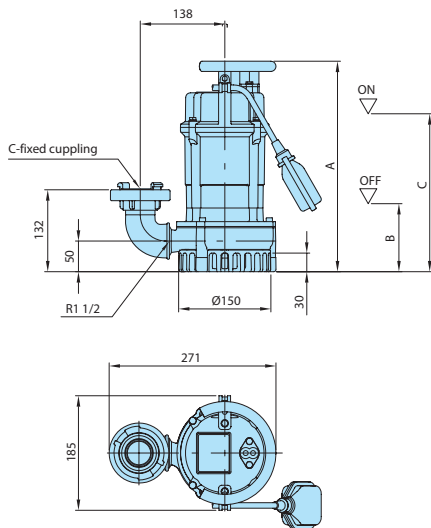

Type	A	B	C
HBPR504 W(A)	340	100	370
HBPR508 W(A)	380	120	400

**Accessories**

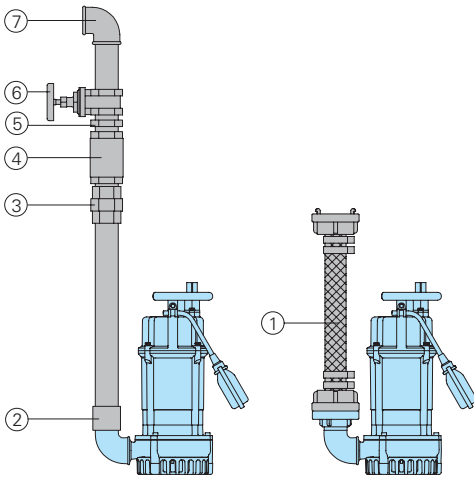

Description	Size	Part no.	Description	Size	Part no.
① Synthetic-pressure hose, with rubber lining, completely with C-couplings	10 m long 15 m long 20 m long 30 m long	2611310 2611315 2611320 2611330	○ Mains-dependent alarm switchgear AL3 with connector for 9 V rechargeable battery (see below) for operation independent of mains power supply, with built-in signal transmitter, float switch and 10 m of cable. Main phase connection 230V/1Ph		1586141
Hose clamp	2"	2306009	Battery 9V for mains-independent alarm		1952215
② Double socket, galvanized	BSP1½" F	2109010	○ For pump controllers and switchgears for mobile and stationary applications, measuring systems and monitoring devices	see HOMA accessories	
③ Transitional screw mounting, galvanized	BSP1½" M/F	2114305			
④ Non-return ball valve GG	BSP1½" F	2212902			
⑤ Double nipple, galvanized	BSP1½" M	2009020			
⑥ Shut-off gate valve, Brass	BSP 1½" F	2216015			
⑦ 90° bend, galvanized	BSP 1½" F	2113605			
T-piece for merging the pressure pipe in double pump stations	BSP 1½" F	2114302			
○ Fault current circuit breaker 2-pin, Fi 16/0.03 A		1561160			

We reserve the right to alter our specifications without notice!